

REVISIONS					
REV.	DATE	ECN#	DESCRIPTION	BY	APPROVED
1	6/20/2014	HJ14-108	REMOVED MAXIMUM CONDITION	CLS	BLB

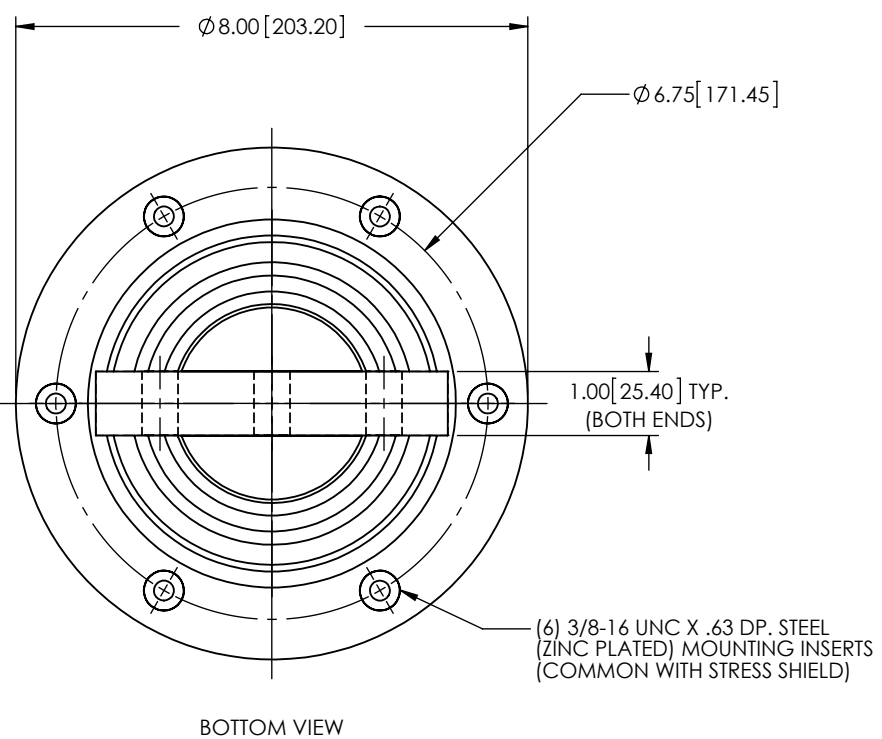
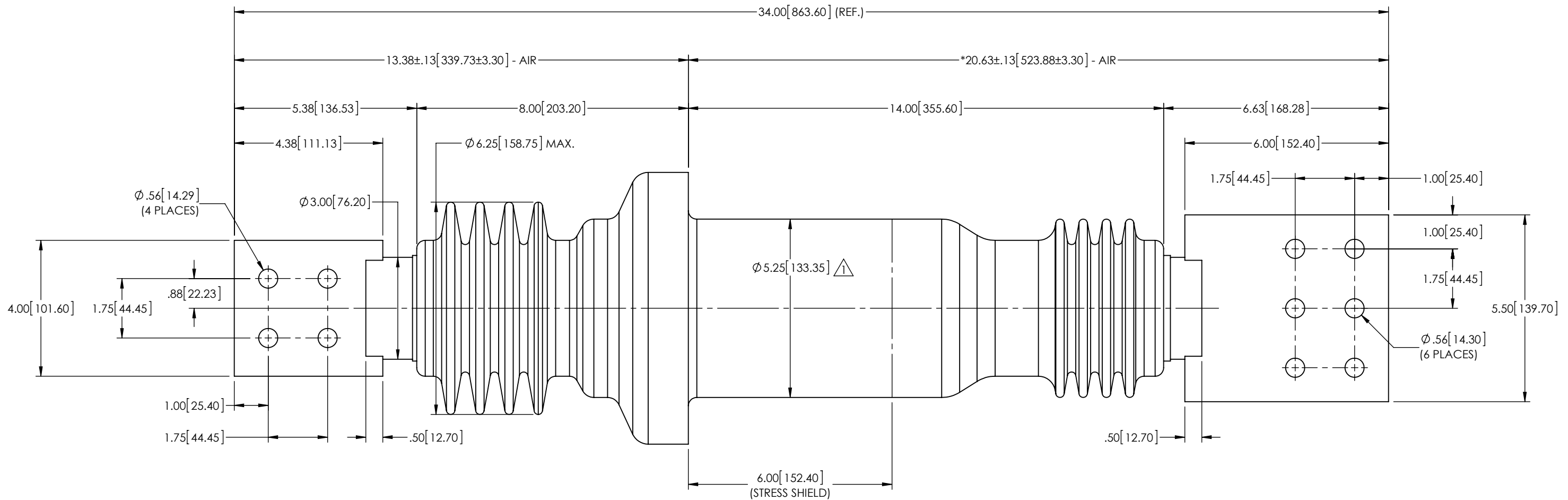

NOTES:
 1. ALL CONTACT SURFACES TO BE CLEAN & FREE FROM FLASH

MATERIAL:
 1. E07 - CYCLOALIPHATIC EPOXY (U.V. EXPOSED), COLOR: GREY
 2. HD ETP COPPER C11000, TIN PLATED - CONDUCTOR

SPECIFICATIONS:
 1. MANUFACTURED IN ACCORDANCE WITH IEC 137-1995, CAN/CSA-C88.1-96, IEEE C57.19.01-1991
 2. RATED VOLTAGE 15kV
 3. POWER FREQUENCY WITHSTAND 50kV
 4. BASIC IMPULSE LEVEL 110kV
 5. NOMINAL CURRENT RATING 4000 AMPS
 6. TEMPERATURE CLASSIFICATION..... -50°C TO +105°C
 7. APPROXIMATE WEIGHT 88 LBS

PROPRIETARY AND CONFIDENTIAL
 THE INFORMATION CONTAINED IN THIS DRAWING IS THE SOLE PROPERTY OF H-J INTERNATIONAL, INC. ANY REPRODUCTION IN PART OR AS A WHOLE WITHOUT THE WRITTEN PERMISSION OF H-J INTERNATIONAL, INC. IS STRICTLY PROHIBITED.

BREAK ALL SHARPS UNLESS OTHERWISE NOTED

TOLERANCES (EXCEPT AS NOTED)	
ONE PLACE MM	±1.50
TWO PLACE MM	±0.75
TWO PLACE DEC.	±.060
THREE PLACE DEC.	±.030
FRACTIONS	± 1/16"
ANGLES	2°

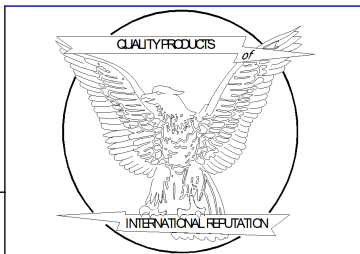

H-J INTERNATIONAL, INC.
 3010 HIGH RIDGE BLVD, HIGH RIDGE, MO. 63049 USA
 PHONE 1-636-677-3421 FAX 1-636-376-1915

15kV / 4000A
POWER APPARATUS BUSHING

APPROVED BY	CJT	DATE	03/07/2013
CHECKED BY	BS	DATE	06/20/2014
DRAWN BY	CLS	DATE	03/07/2013
TOOL NO.	T20-200-8		
PRODUCT GRP.	2000 SERIES		

DRAWING NO.	20-200-802								
SCALE	1:3	SIZE	B	REV.	1	SHEET	1	OF	1